

PVT4 SERIES QUICK COUPLINGS

Flat Face Screw Type - Connectable Under Pressure

Sizes: 1/4" thru 2"

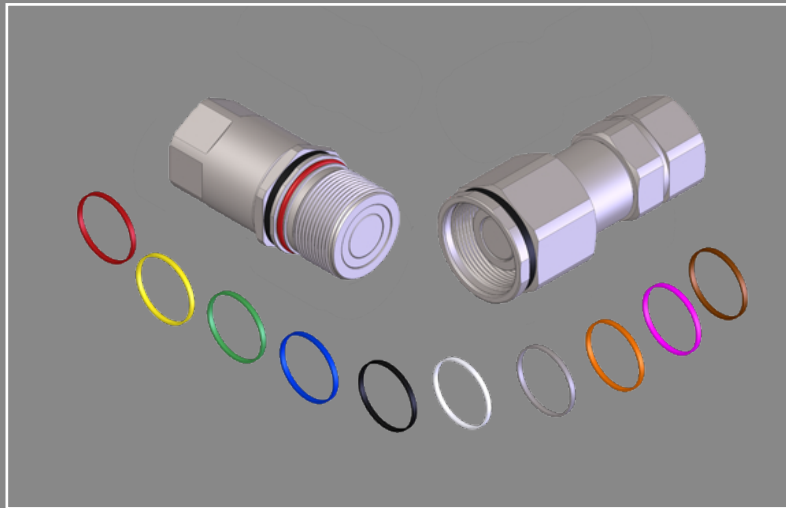
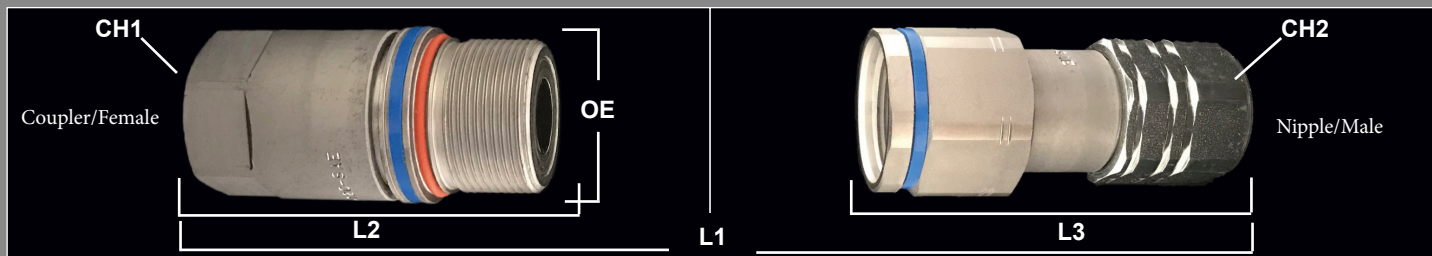

DIMENSIONAL & PRESSURE RATING DATA

Body Size	CH1	CH2	OE	L1	L2	L3	Optimal Flow Rate (GPM)	Max Flow Rate (GPM)	Max Working (PSI)	Fluid Spillage (cc)
04	.86	.86	1.29	4.53	2.66	2.30	3.17	6.34	5,800	.008
06	1.18	1.18	1.417	5.33	3.07	2.90	6.08	12.15	5,075	.010
08	1.42	1.42	1.65	6.14	3.39	3.43	12	24	5,075	.012
12	1.42	1.42	1.65	6.19	3.52	3.39	20	40	5,075	.015
16	1.62	1.62	1.89	7.09	4.13	3.82	26.5	53	5,075	.020
20	2.16	2.16	2.36	8.47	5.03	4.30	50	74	5,075	.030
22	2.16	2.75	2.85	8.44	4.41	5.36	70	120	5,075	.040
24	2.75	2.75	4.13	9.60	6.05	4.67	100	185	4,350	.050
32	3.15	3.15	4.56	11.44	6.81	7.75	200	265	4,350	.100

units: inches

Features and Benefits

- A non-interchangeable upgrade to the FSI Series
- High tech Z-786 anti-corrosion plating salt spray tested for 700 hours before any appearance of surface red rust
- Slimmer design than FSI
- High working pressures
- Seal is blowout resistant to 5,000 PSI when connecting or disconnecting with residual pressure
- Can connect by hand up to 5,000 PSI
- Exceeds 1,000,000 impulse cycles
- Flat face design eliminates spillage upon disconnection
- Thread to connect style coupling eliminates brinelling issues
- Heavy duty hex nut
- Fine threads for smooth makeup
- Standard Threads: NPT, SAE & BSP

Applications

- Used in a wide range of industrial markets where connecting and disconnecting of hydraulic circuits is needed
- High pressure, low pressure drop and high impulse applications
- Drilling Rigs, Cranes, HPU'S, Heavy Equipment, Hammer attachments and much more

Key Note:

- Color Safe System options available



ORDERING INFORMATION

QUICK COUPLING PART NUMBERING SYSTEM:

PVT4-CC - 08 - 08 - C - NPT

PVT4 CC SERIES	Body Size		Body Size		Thread Size		Thread Size		Coupler / Nipple		Thread Type	
Flush Face No Spill Coupling Connect under pressure Color Code	04	1/4"	16	1"	04	1/4"	16	1"	C	Coupler	NPT	NPT
	06	3/8"	20	1-1/4"	06	3/8"	20	1-1/4"	N	Nipple	SAE	O-Ring/UNF
	08	1/2"	22	1-3/8"	08	1/2"	24	1-1/2"			BSP	British Standard Parallel
	12	3/4"	24	1-1/2"	12	3/4"	32	2"				
			32	2"								

PVT4-SS SERIES QUICK COUPLINGS (PVTX)

Flat Face Screw Type - Connectable Under Pressure - 316 Stainless Steel

Sizes: 1/4" thru 2"

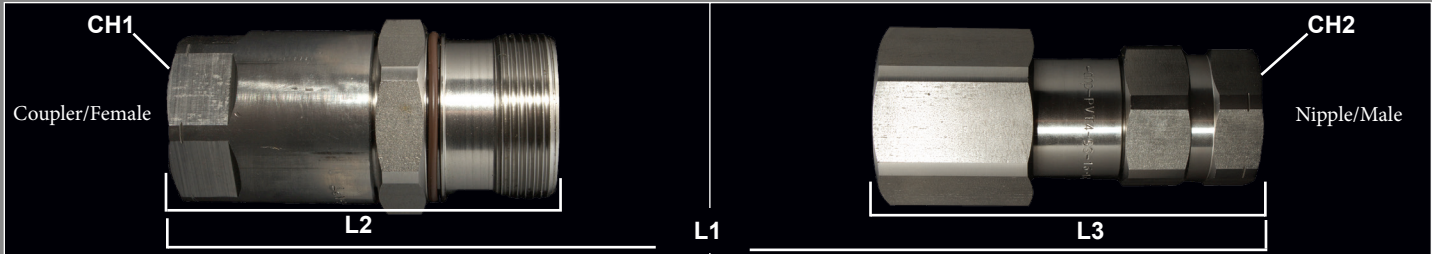

Features and Benefit

- PVT4-SS is the ultimate coupling for the offshore oil and gas market
- 316 SS material for ultimate corrosion resistance
- Slim design makes for easy plumbing in tight spaces
- High working pressures
- Connects and disconnects by hand up to 4,000 PSI
- Seal is blowout resistant to 4,000 PSI when connecting and disconnecting with residual pressure
- Exceeds 1,000,000 impulse cycles
- Flat face design eliminates spillage upon disconnection
- Thread to connect style coupling eliminates brinelling issues
- Heavy Duty Hex Nut
- Standard Threads: NPT, SAE & BSP

Applications

- Offshore and Marine Industry: Drill Ships, FPSO, Oilfield Service and Drilling Equipment, Rig Cranes, Winches, Platforms, Offshore Salvage and Demolition Equipment
- High pressure, low pressure drop, high impulse applications
- Used in a wide range of industrial markets where connecting and disconnecting of hydraulic circuits is needed

Key Note:

- Color Safe System options available



DIMENSIONAL & PRESSURE RATING DATA

Body Size	CH1	CH2	OE	L1	L2	L3	Optimal Flow Rate (GPM)	Max Flow Rate (GPM)	Max Working (PSI)	Fluid Spillage (cc)
04	.86	.86	1.29	4.53	2.66	2.30	3.17	6.34	4,350	.008
06	1.18	1.18	1.417	5.33	3.07	2.90	6.08	12.15	3,625	.010
08	1.42	1.42	1.65	6.14	3.39	3.43	12	24	3,625	.012
12	1.42	1.42	1.65	6.19	3.52	3.39	20	40	3,625	.015
16	1.62	1.62	1.89	7.09	4.13	3.82	26.5	53	3,625	.020
20	2.16	2.16	2.36	8.47	5.03	4.30	50	74	3,625	.030
24	2.75	2.75	4.13	9.60	6.05	4.67	100	185	2,175	.050
32	3.15	3.15	4.56	11.44	6.81	7.75	200	265	2,175	.100

units: inches

ORDERING INFORMATION

QUICK COUPLING PART NUMBERING SYSTEM:

PVT4-CC - SS - 08 - 08 - C - NPT

PVT4-SS-CC SERIES		Material		Body Size		Body Size		Thread Size		Thread Size		Coupler / Nipple		Thread Type	
Flush Face No Spill Coupling Connect under pressure 316 Stainless Steel color code		Stainless Steel		04		16		04		16		C		NPT	NPT
				06		20		06		20		Coupler		SAE	O-Ring/UNF
				08		24		08		24		N		BSP	British Standard Parallel
				12		32		12		32					
				3/4"		2"		3/4"		2"					

PVT4-PINLOCK SERIES QUICK COUPLINGS

Flat Face Screw Type - Connectable Under Pressure- With Pin Lock

Sizes: 1/4" thru 2"

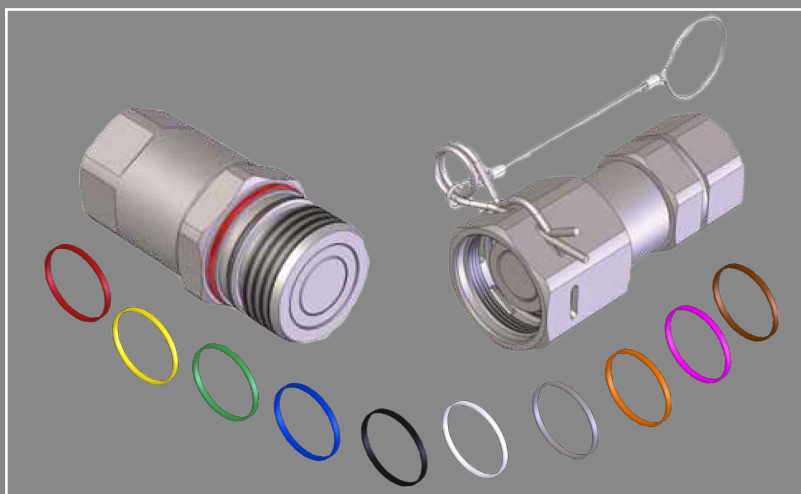
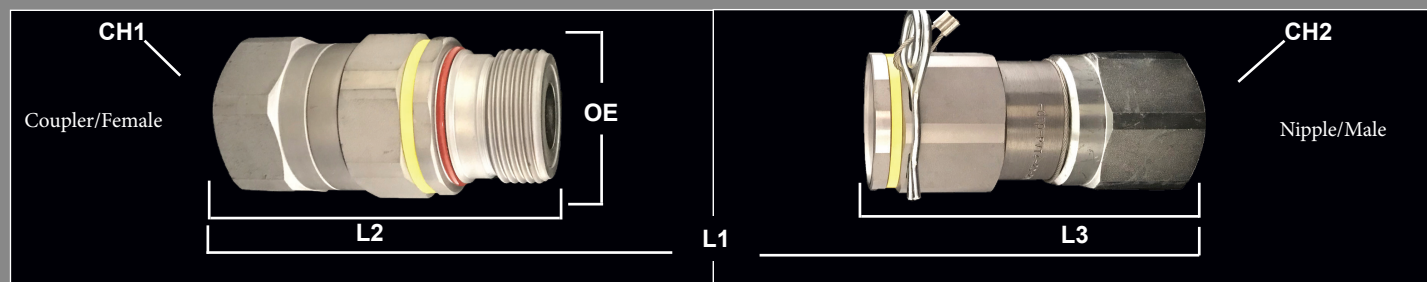

Features and Benefits

- A non-interchangeable upgrade to the FSI Series
- High tech Z-786 anti-corrosion plating salt spray tested for 700 hours before any appearance of surface red rust
- Slimmer design than FSI with no loss in flow rate
- High working pressures
- Seal is blowout resistant to 5,000 PSI when connecting or disconnecting with residual pressure
- Can connect by hand up to 5,000 PSI
- Exceeds 1,000,000 impulse cycles
- Flat face design eliminates spillage upon disconnection
- Thread to connect style coupling eliminates brinelling issues
- Heavy duty hex nut
- Fine threads for smooth makeup
- Additional Pin Lock to ensure no accidental disconnection
- Standard Threads: NPT, SAE & BSP

Applications

- Used in a wide range of industrial markets where connecting and disconnecting of hydraulic circuits is needed
- High pressure, low pressure drop and high impulse applications
- Drilling Rigs, Cranes, HPU'S, Heavy Equipment, Hammer attachments and much more

Key Note:

- Color Safe System options available



DIMENSIONAL & PRESSURE RATING DATA

Body Size	CH1	CH2	OE	L1	L2	L3	Optimal Flow Rate (GPM)	Max Flow Rate (GPM)	Max Working (PSI)	Fluid Spillage (cc)
04	.86	.86	1.29	4.53	2.66	2.30	3.17	6.34	5,075	.008
06	1.18	1.18	1.417	5.33	3.07	2.90	6.08	12.15	5,075	.010
08	1.42	1.42	1.65	6.14	3.39	3.43	12	24	5,075	.012
12	1.42	1.42	1.65	6.19	3.52	3.39	20	40	5,075	.015
16	1.62	1.62	1.89	7.09	4.13	3.82	26.5	53	5,075	.020
20	2.16	2.16	2.36	8.47	5.03	4.30	50	74	5,075	.030
22	2.16	2.75	2.85	8.44	4.41	5.36	70	120	5,075	.040
24	2.75	2.75	4.13	9.60	6.05	4.67	100	185	4,350	.050
32	3.15	3.15	4.56	11.44	6.81	7.75	200	265	4,350	.100

units: inches

ORDERING INFORMATION

QUICK COUPLING PART NUMBERING SYSTEM:

PVT4-SL-CC - 08 - 08 - C - NPT

PVT4-SL CC SERIES	Body Size		Body Size		Thread Size		Thread Size		Coupler / Nipple		Thread Type	
Flush Face No Spill Coupling Connect under pressure sleeve lock color code	04	1/4"	16	1"	04	1/4"	16	1"	C	Coupler	NPT	NPT
	06	3/8"	20	1-1/4"	06	3/8"	20	1-1/4"	N	Nipple	SAE	O-Ring/UNF
	08	1/2"	22	1-3/8"	08	1/2"	24	1-1/2"			BSP	British Standard Parallel
	12	3/4"	24	1-1/2"	12	3/4"	32	2"				
			32	2"								



Features and Benefits

- Easy to use and implement and easy to see at a distance
- Implements the poka-yoke by establishing a mistake-proofing system
- A non-interchangeable upgrade to the FSI Series
- High Tech Z-786 Anti-Corrosion plating salt spray tested for 700 hrs before any appearance of surface red rust
- Slimmer design than FSI with no loss in flow rate
- Seal is blowout resistant to 5,000 PSI when connecting or disconnecting with residual pressure
- Flat face design eliminates spillage upon disconnection
- Thread to connect style coupling eliminates brinelling issues
- Standard Threads: NPT, SAE, BSPP, DIN, Code 62

Applications

- Used in a wide range of industrial markets where connecting and disconnecting of hydraulic circuits is needed
- High pressure, low pressure drop and high impulse applications
- Oilfield: drilling rigs, oilfield service and drilling equipment, cranes, heavy equipment, hammer attachments and much more

Notes: Aluminum caps and plugs play a crucial role in extending the life of the coupling set.

Key Note: Color Bands offered in 10 different colors

QUICK COUPLING PART NUMBERING SYSTEM:

PVT4-CC - 08 - 08 - C - NPT

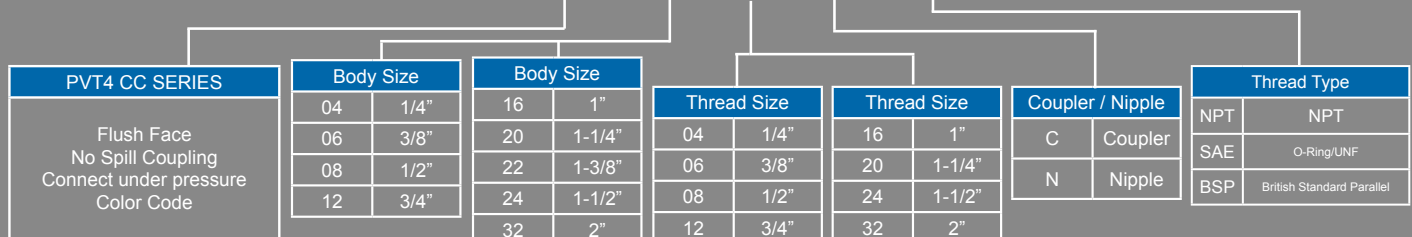

PVT4 - CB - 04 - Blk

