

CV15 -15,000 PSI

High Pressure Check Valves

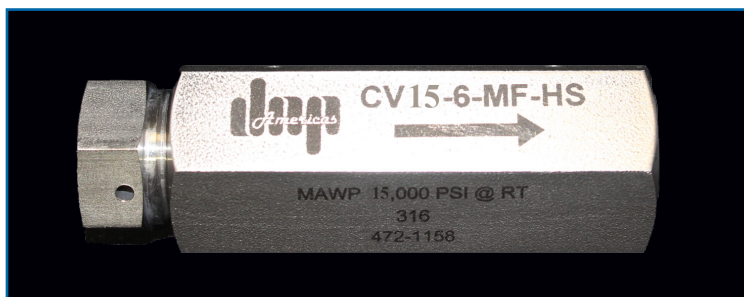

Specifications

Max Working Pressure
15,000 psi (1034 bar)

Temperature Ratings:
-325° to 800° F (-198° to 472° C)

Features and Benefits

- Sizes for 1/4", 3/8" and 1/2"
- Prevents back-flow for non-leak-tight applications
- Ball poppet is designed to assure in-line seating without chatter and to allow maximum flow.

Typical Applications

- Hydrostatic Test Systems
- Waterblast Applications
- Hydraulic Control Panels
- Wire Line Applications
- Instrumentation

Standard Materials of Construction

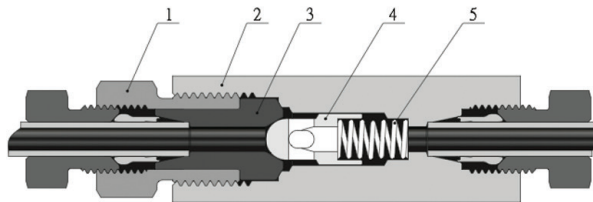

Item	Component	Valve Material
1	Cover Gland	316 SS/A479
2	Valve Body	316 SS/A479
3	Cover	316 SS/A479
4	Ball Poppet	316 SS/A479
5	Spring	300 Series Stainless Steel
	Lubricant	Molybdenum disulfide

Dimensions

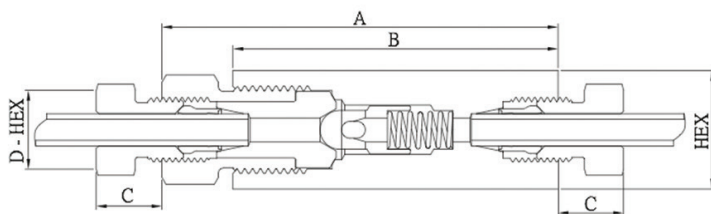

Orifice in.(mm)	Rated Cv	A	B	C	D - HEX	HEX	Pressure/Temperature Rating psig (bar) @ Room Temperature
		in. (mm)					
0.188 (4.78)	0.63	3.18 (80.77)	2.56 (65.02)	0.44 (11.18)	0.63 (16.00)	0.81 (20.57)	15,000 (1034)
0.250 (6.35)	1.70	3.56 (90.42)	3.00 (76.20)	0.53 (13.46)	0.75 (19.05)	1.00 (25.40)	15,000 (1034)
0.375 (9.53)	3.40	4.18 (106.17)	3.50 (88.90)	0.53 (13.46)	0.93 (23.62)	1.38 (35.05)	15,000 (1034)

ORDERING INFORMATION

DNP AMERICAS PART NUMBERING SYSTEM:

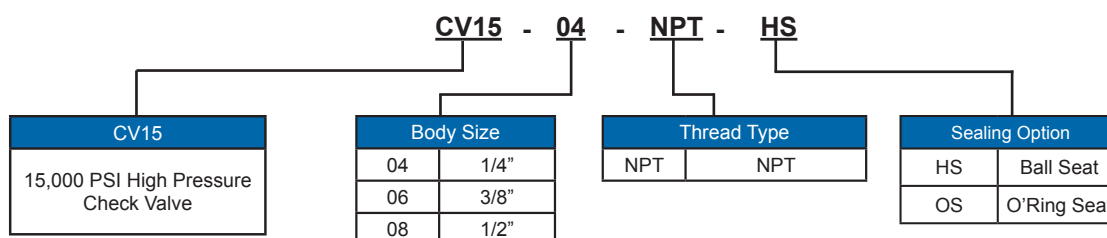

CV20 - 20,000 PSI

High Pressure Check Valves



Specifications

Max Working Pressure
20,000 psi (1379 bar)

Temperature Ratings:
-423° to 1200° F (-252° to 649° C)

Features and Benefits

- Sizes for 1/4", 3/8", 9/16", 3/4" and 1"
- Prevents back-flow for non-leak-tight applications
- Ball poppet is designed to assure in-line seating without chatter and to allow maximum flow.

Standard Materials of Construction

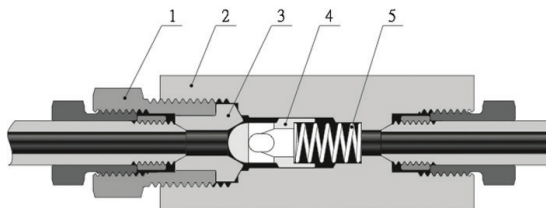

Item	Component	Valve Material
1	Cover Gland	316 SS/A479
2	Valve Body	316 SS/A479
3	Cover	316 SS/A479
4	Ball Poppet	316 SS/A479
5	Spring	300 Series Stainless Steel
	Lubricant	Molybdenum disulfide

Typical Applications

- Hydrostatic Test Systems
- Waterblast Applications
- Hydraulic Control Panels
- Wire Line Applications
- Instrumentation

Dimensions

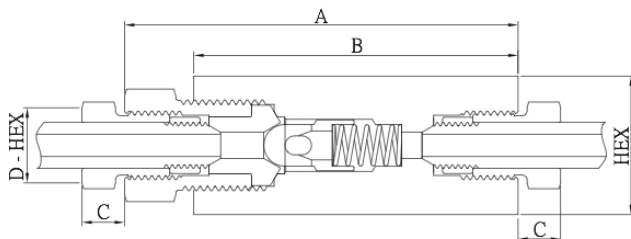

Orifice in.(mm)	Rated Cv	A	B	C	D - HEX	HEX	Pressure/Temperature Rating psig (bar) @ Room Temperature
		in. (mm)					
0.125 (3.18)	0.28	2.94 (74.68)	2.50 (63.50)	0.38 (9.65)	0.50 (12.70)	0.81 (20.57)	20,000 (1379)
0.218 (5.54)	0.84	3.12 (79.25)	2.62 (66.55)	0.47 (11.94)	0.62 (15.75)	1.00 (25.40)	20,000 (1379)
0.359 (9.12)	2.30	4.18 (106.17)	3.50 (88.90)	0.53 (13.46)	0.94 (23.88)	1.38 (35.05)	20,000 (1379)
0.516(13.11)	4.70	5.50 (139.70)	4.75 (120.65)	0.62 (15.75)	1.19 (30.23)	1.75 (44.45)	20,000 (1379)
0.688(17.48)	7.40	6.63 (168.40)	5.75 (146.05)	0.72 (18.29)	1.38 (35.05)	2.12 (53.85)	20,000 (1379)

ORDERING INFORMATION

DNP AMERICAS PART NUMBERING SYSTEM:

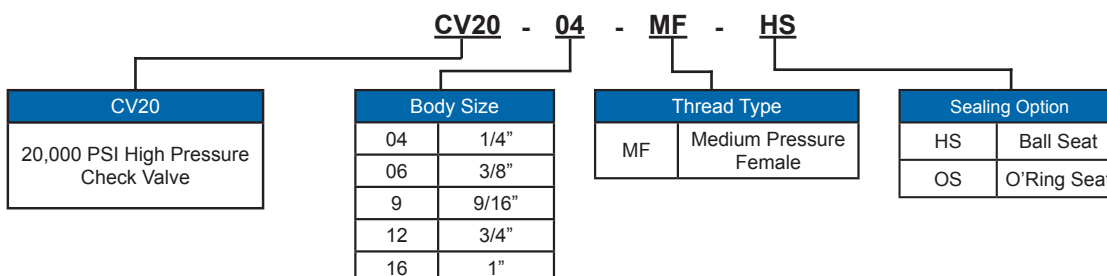

CV60 - 60,000 PSI

High Pressure Check Valves



Specifications

Max Working Pressure
60,000 psi (4137 bar)

Temperature Ratings:
-423° to 1200° F (-252° to 649° C)

Features and Benefits

- Sizes for 1/4", 3/8" and 9/16"
- Prevents back-flow for non-leak-tight applications
- Ball poppet is designed to assure in-line seating without chatter and to allow maximum flow.

Standard Materials of Construction

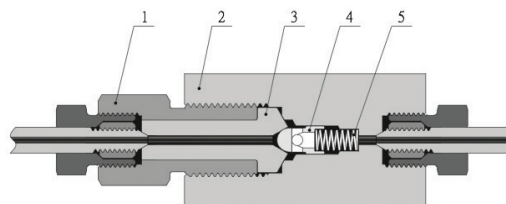

Item	Component	Valve Material
1	Cover Gland	316 SS/A479
2	Valve Body	316 SS/A479
3	Cover	316 SS/A479
4	Ball Poppet	316 SS/A479
5	Spring	300 Series Stainless Steel
	Lubricant	Molybdenum disulfide

Typical Applications

- Hydrostatic Test Systems
- Waterblast Applications
- Hydraulic Control Panels
- Wire Line Applications
- Instrumentation

Dimensions

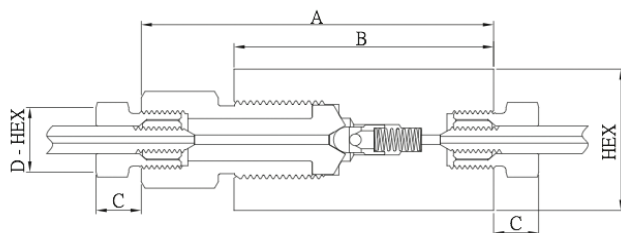

Orifice in.(mm)	Rated Cv	A	B	C	D - HEX	HEX	Pressure/Temperature Rating psig (bar) @ Room Temperature
		in. (mm)					
0.094 (2.39)	0.15	3.38 (85.85)	2.50 (63.50)	0.50 (12.70)	0.63 (16.00)	1.18 (29.97)	60,000 (4137)
0.125 (3.18)	0.28	3.75 (95.25)	2.62 (66.55)	0.53 (13.46)	0.75 (19.05)	1.18 (29.97)	60,000 (4137)
0.187(4.75)	0.63	4.62 (117.35)	3.38 (85.85)	0.81 (20.57)	1.12 (28.45)	1.50 (38.10)	60,000 (4137)

ORDERING INFORMATION

DNP AMERICAS PART NUMBERING SYSTEM:

